

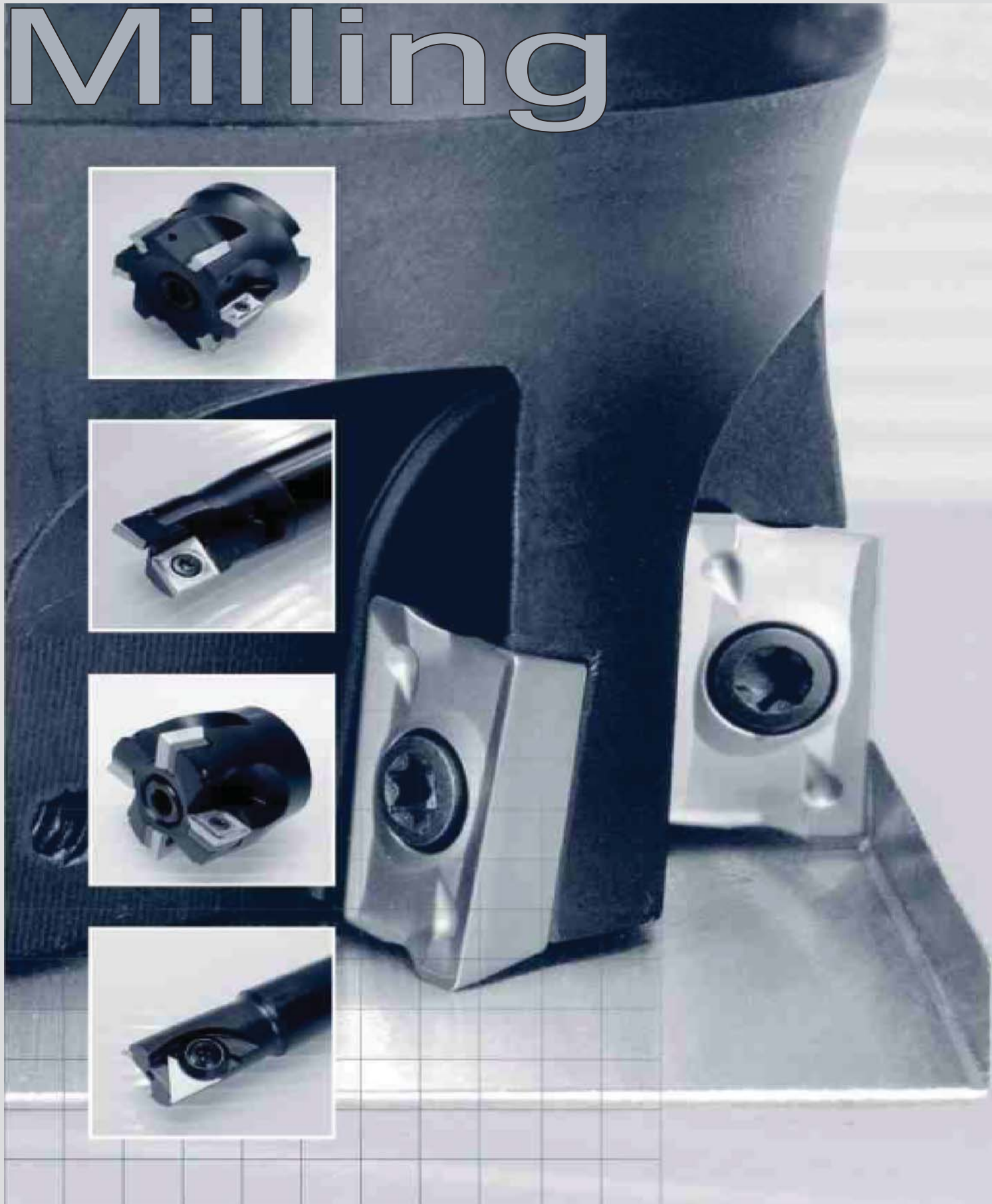

# Milling

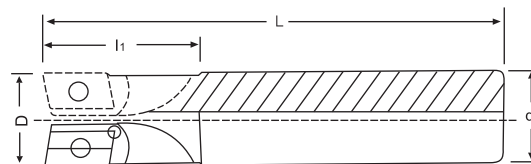

## AKT(End Milling Cutter)



Designation	Available Inserts 	D	d	L	l <sub>1</sub>	Teeth	Parts	
							Screw	Wrench
AKT20S-1010-100L	APXT11T3□□	10	10	100	25	1	M2.5×5.5	T-8
AKT20S-1212-100L		12	12	100	30	1		
AKT20S-1414-100L		14	16	100	30	1		
AKT20S-1616-120L		16	16	120	30	2		
AKT20S-1616-160L		16	16	160	30	2		
AKT20S-1818-160L		18	20	160	35	2		
AKT20S-2020-100L		20	20	100	30	2		
AKT20S-2020-160L		20	20	160	35	2		
AKT20S-2020-200L		20	20	200	35	2		
AKT20S-2220-120L		22	20	120	35	3		
AKT20S-2525-120L		25	25	120	35	3		
AKT20S-3232-120L		32	32	120	40	4		
AKT20S-4032-130L		40	32	130	45	5		
AKT20S-5032-130L		50	32	130	45	6		
AKT20S-6332-130L		63	32	130	45	8		
AKT30S-2020-100L	APKT1604□□ APXT1604□□	20	20	100	30	2	M4×7.5	T-15
AKT30S-2020-150L		20	20	150	30	2		
AKT30S-2525-120L		25	25	120	35	2		
AKT30S-2525-120L-3T		25	25	120	35	3		
AKT30S-2525-150L		25	25	150	40	2		
AKT30S-2525-200L		25	25	200	40	2		
AKT30S-2525-250L		25	25	250	40	2		
AKT30S-2525-300L		25	25	300	40	2		
AKT30S-3232-130L		32	32	130	40	2		
AKT30S-3232-130L-3T		32	32	130	40	3		
AKT30S-3232-150L		32	32	150	45	2		
AKT30S-3232-250L-3T		32	32	250	45	3		

Designation	Available Inserts 	D	d	L	I <sub>1</sub>	Teeth	Parts	
							Screw	Wrench
AKT30S-3232-300L-3T	APKT1604□□ APXT1604□□	32	32	300	25	3	M4×7.5	T-15
AKT30S-3532-200L-3T		35	32	200	45	3		
AKT30S-3532-250L-3T		35	32	250	45	3		
AKT30S-3532-300L-3T		35	32	300	45	3		
AKT30S-4032-130L		40	32	130	42	4		
AKT30S-5032-130L		50	32	130	45	5		
AKT30S-6332-130L		63	32	130	45	6		

FMRC(Face Milling Cutter)

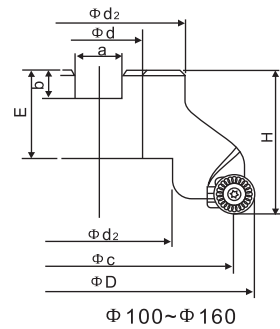
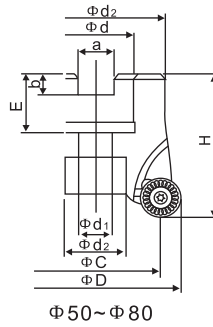

Designation	Available Inserts 	D	D <sub>1</sub>	D <sub>2</sub>	d	d <sub>1</sub>	L	Teeth	Parts			
									Screw for inserts	Clamp	Screw for Clamp	Wrench
FMRC-5R50	RPMT10T3	50	40	18	22.225(22)	8.4(10.5)	50	4	M4×7.5	HR-5R	HR-M3.5	T-15
FMRC-5R63		63	53	18	22.225(22)	8.4(10.5)	50	5				
FMRC-5R80		80	70	22	25.4(27)	9.75(12.5)	50	6				
FMRC-5R100		100	90	45	31.75(32)	12.95(14.5)	50	7				
FMRC-6R50	RPMT1204	50	38	18	22.225(22)	8.4(10.5)	50	4	M4×7.5	HR-6R	HR-M5S	T-15
FMRC-6R63		63	51	18	22.225(22)	8.4(10.5)	50	4				
FMRC-6R80		80	68	22	25.4(27)	9.75(12.5)	50	5				
FMRC-6R100		100	88	45	31.75(32)	12.95(14.5)	50	6				
FMRC-6R-125		125	113	56	38.1(40)	16.15(16.5)	63	7				

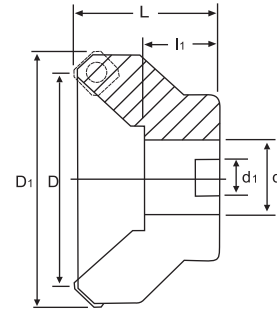
**KM(Face Milling Cutter)**

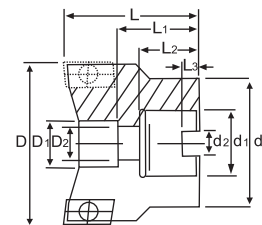

Designation	Available Inserts 	D	D <sub>1</sub>	d	d <sub>1</sub>	L	L <sub>1</sub>	Teeth	Parts	
									Screw for insert	Wrench
KM-50	SEHT1204	50	63	22.225(22)	8.4(10.5)	40	20	4	M5×12	T-20
KM-63		63	76	22.225(22)	8.4(10.5)	45	23	5		
KM-80		80	95	25.4(27)	9.75(12.5)	32	30	6		
KM-100		100	115	31.75(32)	12.95(14.5)	47	30	6		
KM-125		125	140	38.1(40)	16.15(16.5)	63	32	8		

**AMC(Face Milling Cutter)**

Designation	Available Inserts 	D	D <sub>1</sub>	D <sub>2</sub>	d	d <sub>1</sub>	d <sub>2</sub>	L	L <sub>1</sub>	L <sub>2</sub>	L <sub>3</sub>	Teeth	Parts	
													Screw for inserts	Wrench
AMC30S-50	APXT1604 APKT1604	50	19	11	40	22.225(22)	8.4(10.5)	50	33	26	5.0(6.3)	5	M4×7.5	T-15
AMC30S-63		63	19	11	50	22.225(22)	8.4(10.5)	50	33	26	5.0(6.3)	6		
AMC30S-80		80	20	13	60	25.4(27)	9.75(12.5)	50	33	32	6.0(7.0)	7		
AMC30S-100		100	45	-	60	31.75(32)	12.95(14.5)	50	-	32	8.0(8.0)	8		
AMC30S-125		125	60	-	85	38.1(40)	16.15(16.5)	63	-	38	10.0(10.0)	8		

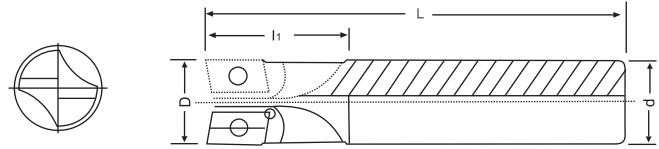
## AMS(End Milling Cutter)



Designation	Available Inserts	D	d	L	l <sub>1</sub>	Teeth	Parts	
							Screw	Wrench
AMS20S-1012-100L	APMT1135PDER	10	12	100	25	1	M2.5×5.5	T-8
AMS20S-1212-100L		12	12	100	30	1		
AMS20S-1616-120L		16	16	120	30	2		
AMS20S-1616-160L		16	16	160	35	2		
AMS20S-2020-120L		20	20	120	35	2		
AMS20S-2020-150L		20	20	150	35	2		
AMS20S-2020-200L		20	20	200	40	2		
AMS30S-2525-150L	APMT1604PDER	25	25	150	40	2	M4×7.5	T-15
AMS30S-2525-250L		25	25	250	40	2		
AMS30S-2525-300L		25	25	300	40	2		
AMS30S-3232-150L		32	32	150	45	2		
AMS30S-3232-250L		32	32	250	45	2		
AMS30S-3232-250L		32	32	250	45	3		
AMS30S-3232-300L		32	32	300	45	3		
AMS30S-3532-200L		35	32	200	45	3		
AMS30S-3532-250L		35	32	250	45	3		
AMS30S-3532-300L		35	32	300	45	3		



## FMRS(End Milling Cutter)

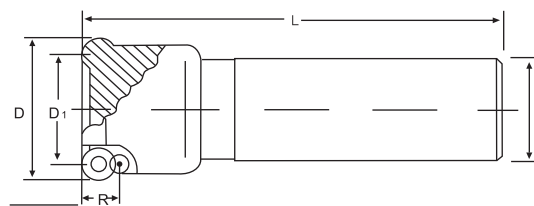

Designation	Available Inserts 	D	D <sub>1</sub>	d	L	R	Teeth	Parts			
								Screw for inserts	Clamp	Screw for Clamp	Wrench
FMRS-4R1616-160L	RPMT0802	16	10	16	160	4R	2	M2.5×5.5	-	-	T-8
FMRS-4R2020-160L		20	12	20	160	4R	2				
FMRS-4R1616-200L		20	12	20	200	4R	2				
FMRS-5R2020-160L	RPMT10T3	20	12	20	160	5R	2	M4×7.5	HR-5R	HR-M3.5	T-15
FMRS-5R2020-200L		20	12	20	200	5R	2				
FMRS-5R2525-160L		25	15	25	150	5R	2				
FMRS-5R2525-200L		25	15	25	200	5R	2				
FMRS-5R3025-160L		30	20	25	160	5R	2				
FMRS-5R3025-200L		30	20	25	200	5R	2				
FMRS-5R3025-250L		30	20	25	250	5R	2				
FMRS-5R3532-150L		35	25	32	150	5R	3				
FMRS-5R3532-200L		35	25	32	200	5R	3				
FMRS-5R3532-250L		35	25	32	250	5R	3				
FMRS-5R3532-300L		35	25	32	300	5R	3				
FMRS-6R3225-200L	RPMT1204	32	20	25	200	6R	2	M4×7.5	HR-6R	HR-M4	T-15
FMRS-6R3232-200L		32	20	32	200	6R	2				
FMRS-6R3532-200L		35	25	32	200	6R	2				
FMRS-6R3532-250L		35	25	32	250	6R	2				
FMRS-6R3532-300L		35	25	32	300	6R	2				
FMRS-6R4032-200L		40	28	32	200	6R	3				
FMRS-6R4032-250L		40	28	32	250	6R	3				

## Feature:

Used by processing of three-dimension mould.

With round inserts,high economic efficiency,speed,and precision