

# Threading

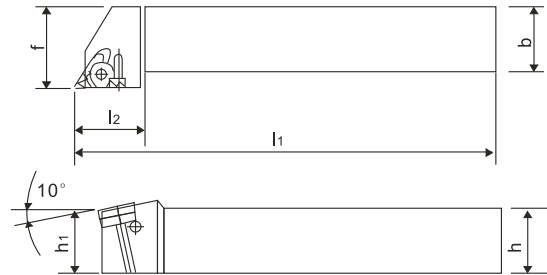

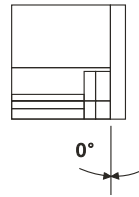

Designation	Available Inserts	h	b	l <sub>1</sub>	l <sub>2</sub>	h <sub>1</sub>	f	Parts			
								Shim	Screw for insert	Shim screw	Wrench
SER/L-1010H11	11ER/L□□□□	10	10	100	18	10	12	X	M2.5×8	X	T-8
SER/L-1212H16	16ER/L□□□□	12	12	100	22	12	16		M3.5×9		T-15
SER/L-1616H16		16	16	100	22	16	20	STM16(R) STM16(L)	M3.5×12	M3×6N	T-15
SER/L-2020K16		20	20	125	22	20	25				
SER/L-2525M16		25	25	150	22	25	32				
SER/L-3232P16		32	32	170	22	32	40	STM22(R) STM22(L)	M4×16	M4×8N	T-20
SER/L-2525M22	25	25	150	28	25	32					
SER/L-3232P22	32	32	170	32	32	40					
SER/L-4040S22	40	40	250	36	40	40					
SER/L2525M27	27ER/L□□□□	25	25	150	34	25	32	STM27(R) STM27(L)	M5×16	M5×8N	T-20
SER/L-3232P27		32	32	170	34	32	40				
SER/L-4040S27		40	40	250	40	40	40				
SER/L-5050T27		50	50	300	40	50	40				

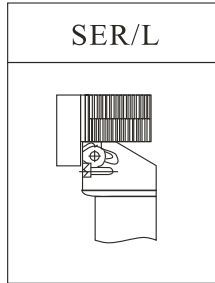
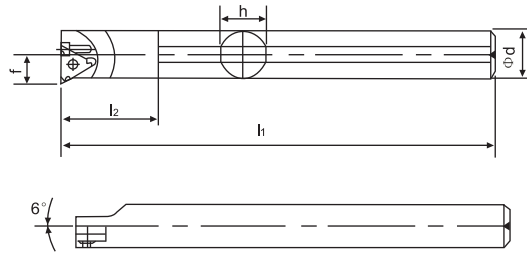
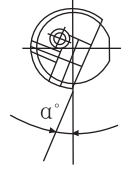
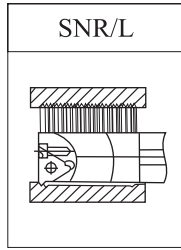

Designation	Available Inserts	Parts											
		D <sub>MIN</sub>	h	b	l <sub>1</sub>	l <sub>2</sub>	h <sub>1</sub>	f					
									Shim	Screw for insert	Shim screw	Wrench	
SNR/L0010K11	11NR/L□□□□	Φ 12	10	7.4	125	25	9	21°	X	M2.5×8	X	T-8	
SNR/L0012K11		Φ 15	12	8.4	125	32.5	11	15°					
SNR/L0010K11-A16		Φ 12	16	7.4	125	30	15	15°					
SNR/L0012K11-A16		Φ 15	16	8.4	125	36	15	15°					
SNR/L0013M16	16NR/L□□□□	Φ 16	16	10.2	150	32	15	17°	STM16(R) STM16(L)	M3.5×9	M3×6N	T-15	
SNR/L0016M16		Φ 19	16	11.7	150	40	15	15°					
SNR/L0020Q16		Φ 24	20	13.7	180	40	19	21°					
SNR/L0020R16		Φ 24	20	13.7	200	40	19	21°					
SNR/L0025R16		Φ 29	25	16.2	200	45	24	21°					
SNR/L0032S16		Φ 36	32	19.7	250	50	30	15°					
SNR/L0040T16		Φ 44	40	23.7	300	55	38	15°					
SNR/L0050U16		Φ 54	50	28.7	350	60	48	15°					
SNR/L0020Q22	22NR/L□□□□	Φ 23	20	15.6	180	45	19	15°	X	M4×16	X	T-20	
SNR/L0025R22		Φ 29	25	18.1	200	47	24	21°	STM22(R) STM22(L)		M4×8N		
SNR/L0032S22		Φ 38	32	21.6	250	55	30	15°					
SNR/L0040T22		Φ 46	40	25.6	300	60	38	15°					
SNR/L0050U22		Φ 56	50	30.6	350	70	48	15°					
SNR/L0040T27	27NR/L□□□□	Φ 48	40	26.6	300	65	38	15°	STM27(R) STM27(L)	M5×16	M5×8N	T-20	
SNR/L0050U27		Φ 58	50	31.6	350	75	48	15°					